

REVISION RECORD					
REV	ECO	DESCRIPTION	DRFT	DATE	
△		Drawing emend	Home	04/07/06*	
△		增加商标、品名、UL刻字	WLM	08/06/08*	
△		增加VDE, CE刻字	Zengy	01/15/09*	

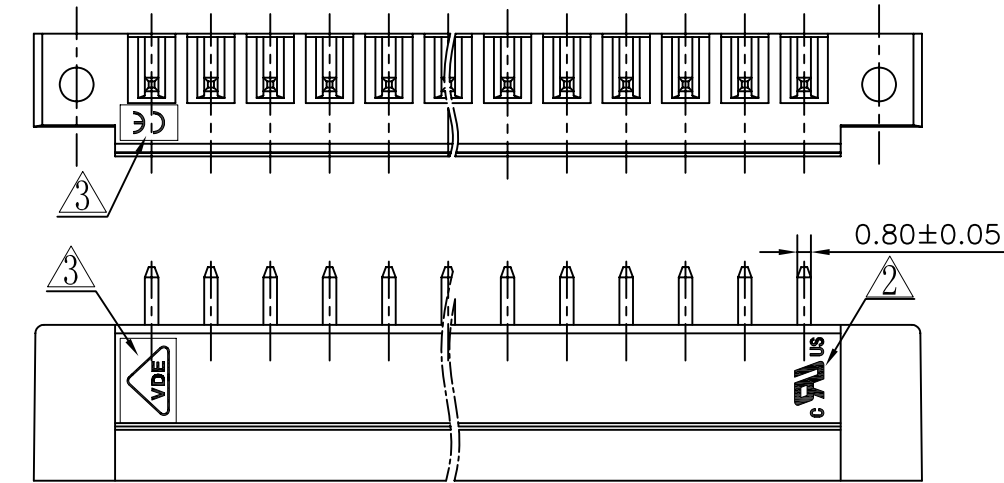

Notes:

1. Pitch: 3.5mm poles:2-24p
2. Rated voltage/current: UL 300V/8A
VDE 250V/7A
3. Operation temperatures:-40° C~+105° C
4. Withstanding voltage: AC2000V/1min
5. Insulation resistance:5000MΩ/DC1000V
6. Undimensioned Tolerances:

Pitch range in mm			Nominal dimension range in mm					—
to 6	over 6 to 10	over 10 to 24	to 30	over 30 to 60	over 60 to 100	over 100 to 150	150	∩
±0.10	±0.15	±0.25	±0.2	±0.3	±0.5	±0.7	±1.0	∇

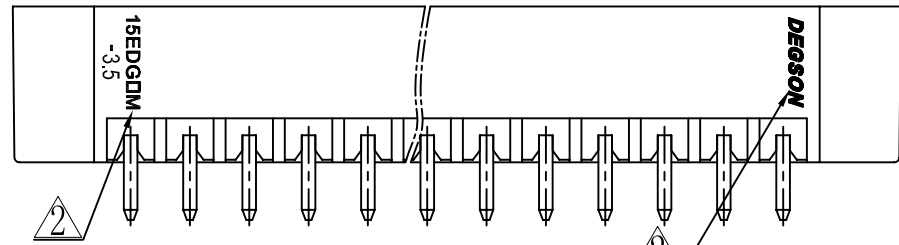
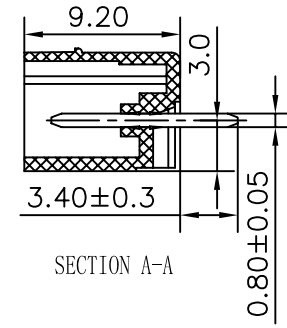
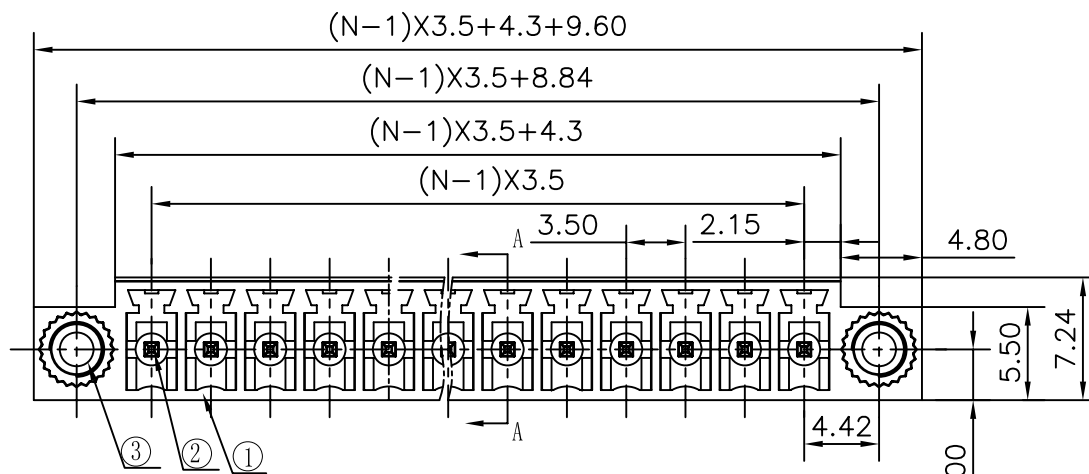

3	2EDG-screw cap	S000000040 (H)	2	Brass	
2	15EDGVC Pin header	1002B00010 (H)	XX	Brass	SnCe

ITEM	NAME OF PART	NO. OF PART	Q"TY	MATERIAL	NOTES
1	15EDGVM-3.5 housing	1040A0YXXA (H)	1	PA66	UL94V-0
TOLERANCES EXCEPT AS NOTED		DFTO: Zhuwm		DATE: 01/24/05*	
MM (INCH)		CHKD		DATE	
.00 ±		MFO		DATE	
.000 ±		APPVL		DATE	
ANGLES ± 1°		G.E :		MATERIAL :	
THIRD ANGLE PROJECTION		FINISH :		NAME	
		SCALE : 1:1		15EDGVM-3.5-XXP-1Y-00A(H)	
		DO NOT SCALE DRAWING		DRAWING NO. 15EDGVM-3.5-E01	
		SHEET 1 OF 1		/PART NO.	
				SIZE A3	
				REV T3 01/15/09*	