

REVISION RECORD				
REV	ECD	DESCRIPTION	DRFT	DATE
△		00A改为300A	LIN	12/03/08
△		增加VDE, CE刻字	Zengy	04/27/09

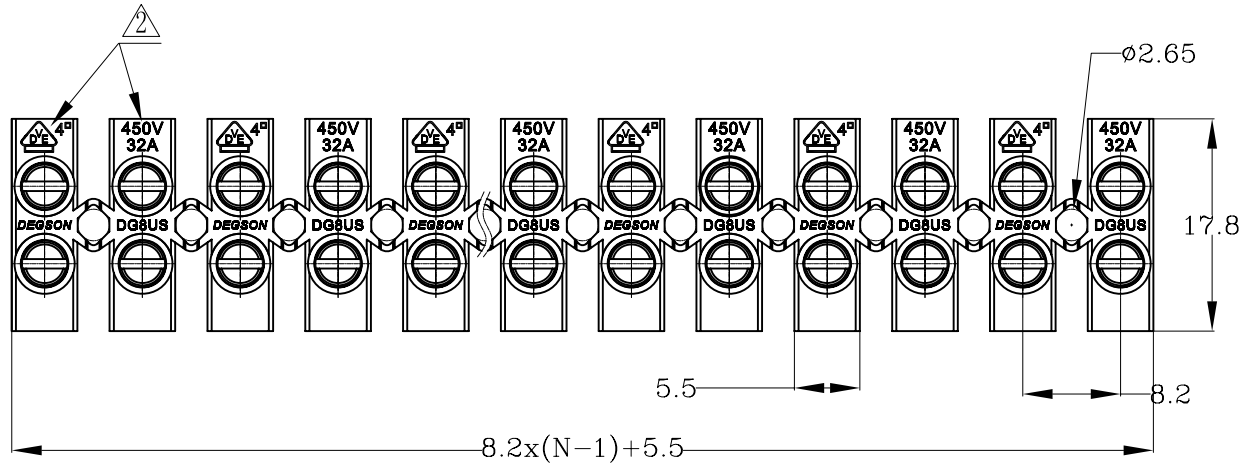

Notes:

- Pitch: 8.2, Poles: 12P
- Rated voltage/Current: UL1059 300V 15A
VDE 450V 32A
- Operation temperatures: -5°C ~ +80°C
- Withstanding Voltage: AC2500V/1Min
- Insulation Resistance: 5000MΩ/DC1000V
- Wire Range: 20-14AWG, 0.5-4mm²
- Max. Torque Value: M2.5, 4.08kgf.cm
- Undimensioned Tolerances:

Pitch range in mm		Nominal dimension range in mm							
	over 6	over 10	over 30	over 60	over 100	over 150	∩		
to	to 10	to 24	to 30	to 60	to 100	to 150	∇		
	±0.10	±0.15	±0.25	±0.2	±0.3	±0.5	±0.7	±1.0	0.05/0

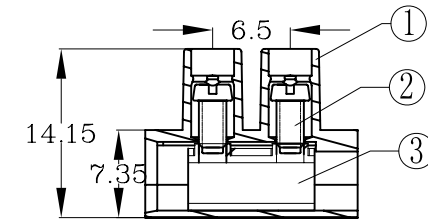
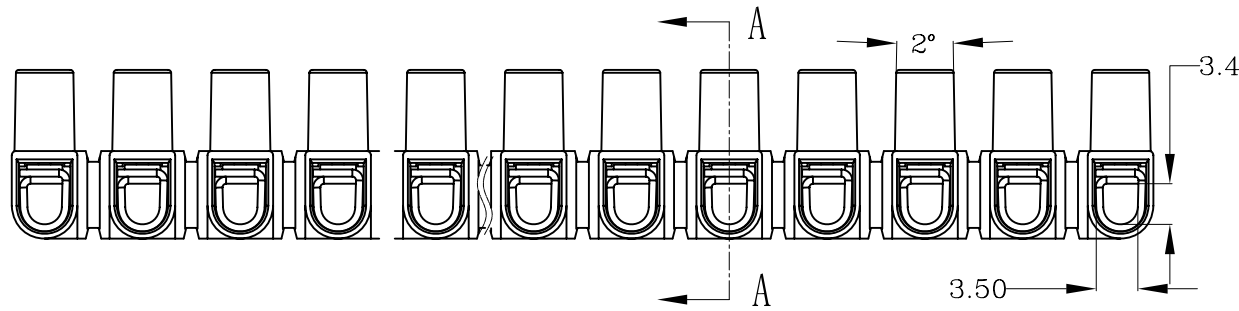

SECTION A-A

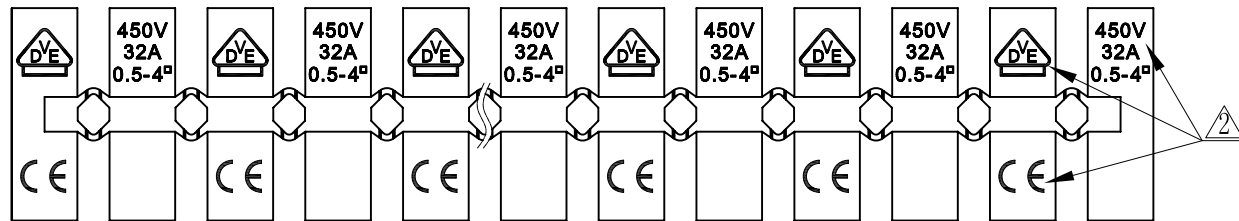

3	DG8HS-Current carrier	X000002140 (H)	XX	Steel	Cr ³⁺ Zn
2	DG8H"-Screws M2.5	S000001110	XX*2	Steel	Cr ³⁺ Zn

1	DG8US Housing	2054A0YXXA (H)	1	PP	UL94V-2
ITEM	NAME OF PART	NO. OF PART	Q'TY	MATERIAL	NOTES
DETACHED LISTS	MM (INCH)	DF TO LIN	DATE	04/30/08	
	TOLERANCES EXCEPT AS NOTED	CHKD	DATE		
		MFD	DATE		
		APPVL	DATE		
		MATERIAL :			
	ANGLES ± 1°	G.E :			
	FINISH:				
	THIRD ANGLE PROJECTION	SCALE :	DD NDT SCALE DRAWING		
		NAME		DG8US-XXP-1Y-300A(H)	
		DRAWING NO.		DG8US-E01	
		/PART NO.			
		SIZE		A3	
		REV		T2	
		DATE		04/27/09	
			SHEET 1		OF 1